

DIR (H.O.)
SITE (HARYANA)
CTP (HARYANA)

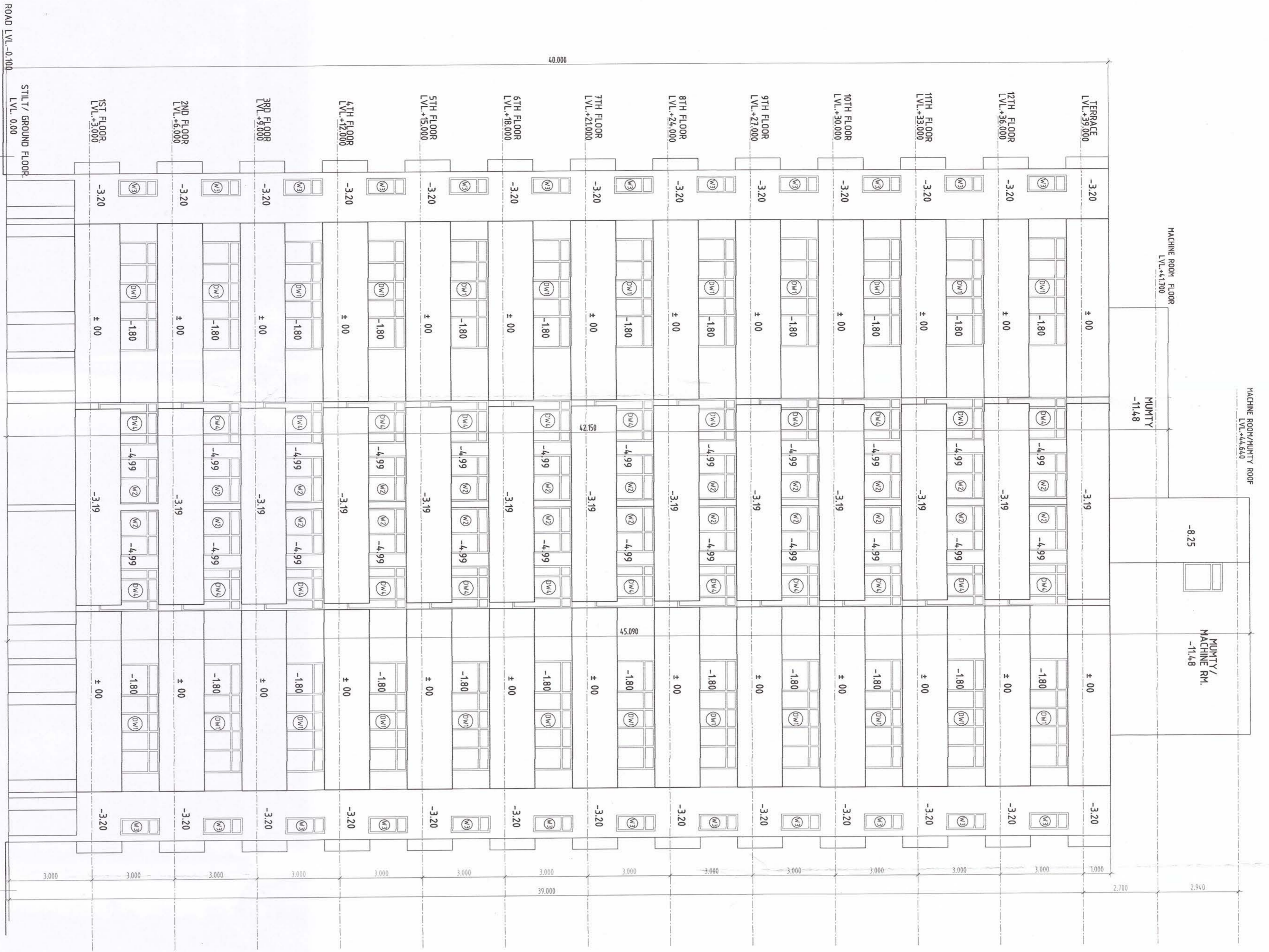

ELEVATION-04
TYPE-A4(BLOCK-9)

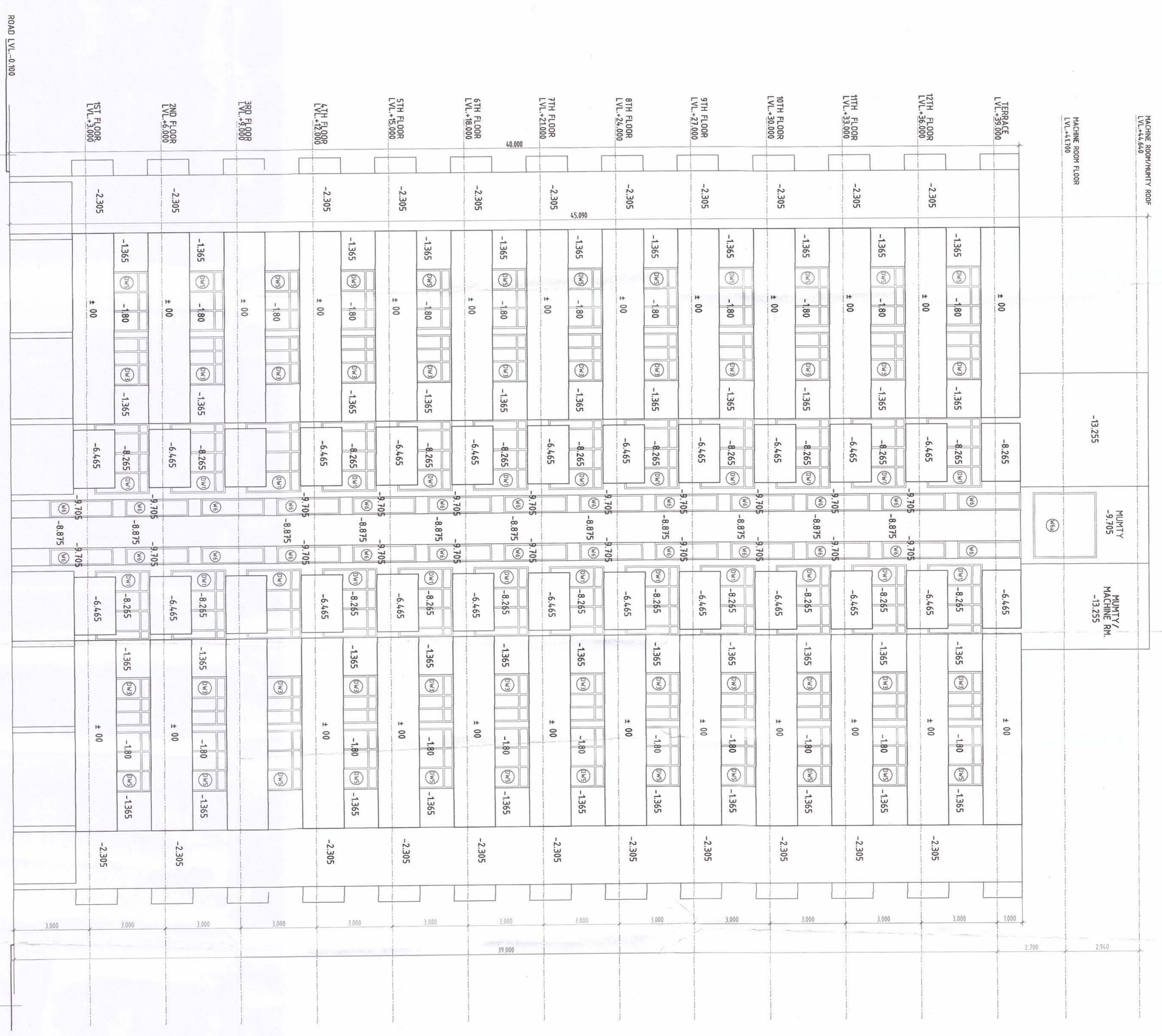

ELEVATION-05
TYPE-A5(BLOCK-10)

REVISED BUILDING PLANS OF
LICENSE NO 474-682 OF
2006 DT. 28-02-2006 FOR SETTING UP
OF A GROUP HOUSING COLONY IN SEC-8,
VILL. KAMASPUR, SONPAT.
FOR
APEX BUILTECH (P) LTD.

PROJECT
APEX GREEN
RESIDENTIAL SCHEME AT MAIN G.T. ROAD,
4.5 KM/1/2 MILE STONE
VILLAGE DAMASPUR, DIST. SONEPAT, HARYANA

ELEVATION 04&05
TYPE-A4, A5 (BLOCK-9&10)

SCALE 1:100
all dimensions in mts

OWNERS SIGN

For APEX BUILTECH LTD.
DIRECTOR

Architect's Sign

APRCHITECTS SIGN

ARCHITECTS SIGN

DRAWING NO. 08